

Preliminary Site Analysis Plan

Lot 703

Radford Parkway, Radford Park, Branxton

LEGEND

-  Design surface contour
-  Drainage Swale
-  Tree
-  Street Tree

Note:

Underground Electricity, NBN, Potable Water, Town Sewer & Natural Gas Available

M.G.A.

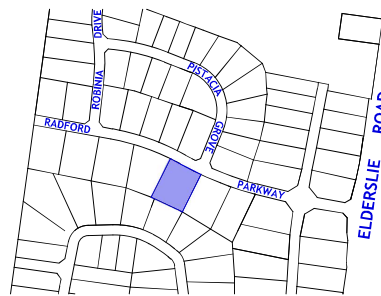

SITE PLAN



RADFORD PARK

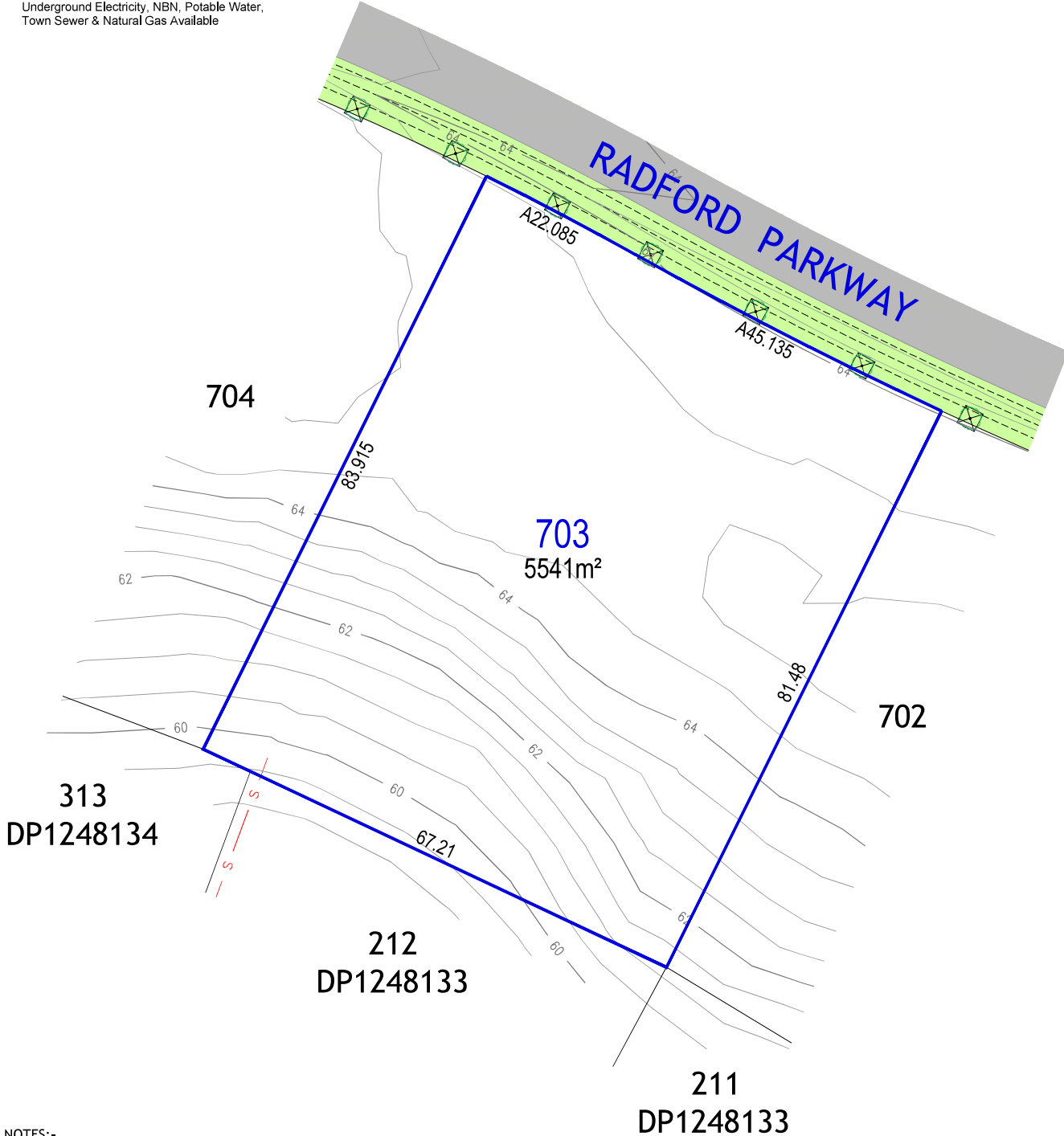

NOTES:-

1. CONTOURS ARE BASED ON FINISHED DESIGN LEVELS AND ARE SUBJECT TO CONSTRUCTION AND COUNCIL CERTIFICATION AND THEREFORE SHOULD NOT BE CONSIDERED AS FINAL OR AS-BUILT. CONTOUR INTERVAL SHOWN IS 0.5m.
2. NO SERVICES HAVE BEEN SHOWN. FINAL LOCATION OF ALL SERVICES TO BE DETERMINED ONSITE PRIOR TO COMMENCEMENT OF ANY CONSTRUCTION OR EXCAVATION.
3. SURVEY INFORMATION SUCH AS BOUNDARY DIMENSIONS AND AREAS, EASEMENTS ETC ARE SUBJECT TO FINAL SURVEY. PURCHASERS SHOULD REFER TO THE DEPOSITED PLAN AND 88B INSTRUMENT CONTAINED IN THE CONTRACT FOR SALE OF LAND FOR FURTHER DETAILED INFORMATION.
4. THE PRELIMINARY SITE ANALYSIS PLAN HAS BEEN COLLATED FROM VARIOUS SOURCES OF DESIGN INFORMATION AND IS PROVIDED FOR CONVENIENCE TO ASSIST PURCHASERS IN OBTAINING QUOTATION/TENDERS FOR DWELLING CONSTRUCTION.
5. THIS DOCUMENT DOES NOT FORM PART OF THE CONTRACT OF SALE OF THE LAND.

"COPYRIGHT NOTICE" THIS PLAN AND THE INFORMATION IT CONTAINS ARE COPYRIGHT AND REMAIN THE PROPERTY OF ADW JOHNSON Pty Ltd. ADW JOHNSON Pty Ltd GRANTS TO THE CLIENT NAMED ON THIS PLAN A LICENCE TO USE THE INFORMATION HEREON FOR THE PURPOSE FOR WHICH WE WERE ENGAGED TO PERFORM THE WORK. USE OF THE PLAN AND INFORMATION IT CONTAINS FOR ANY OTHER PURPOSE IS NOT PERMITTED UNLESS PRIOR WRITTEN APPROVAL HAS BEEN OBTAINED FROM ADW JOHNSON Pty Ltd.

A	21/06/2021	Preliminary Issue	AM
Ver.	Date	Comment	By



BELFORD
EST. 2008

www.radfordpark.com.au
ph: 1 300 7 82 8 85